

Maintenance "Euro" Handle Fork Drive

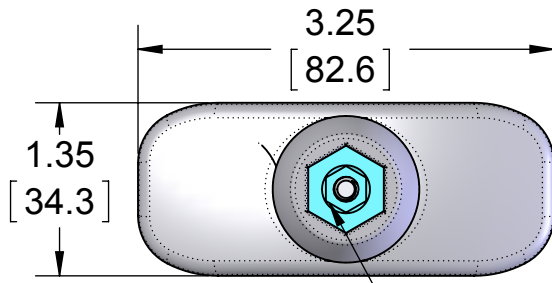

(With cap removed)
Uses 5/16" or 8mm security
hex key.

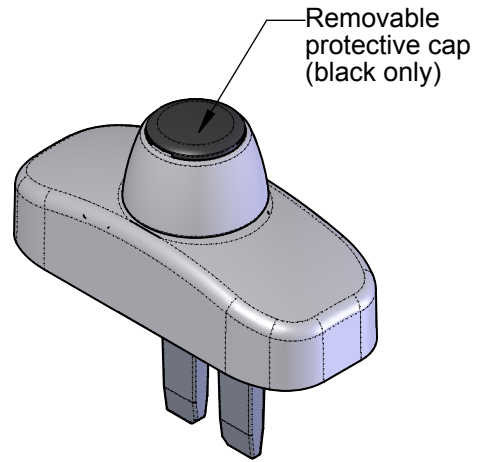

1.48
[37.7]

0.84
[21.3]

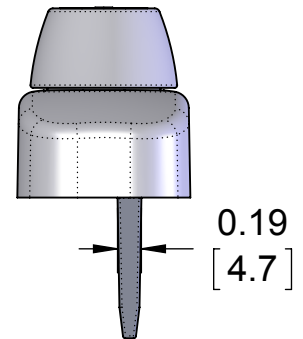
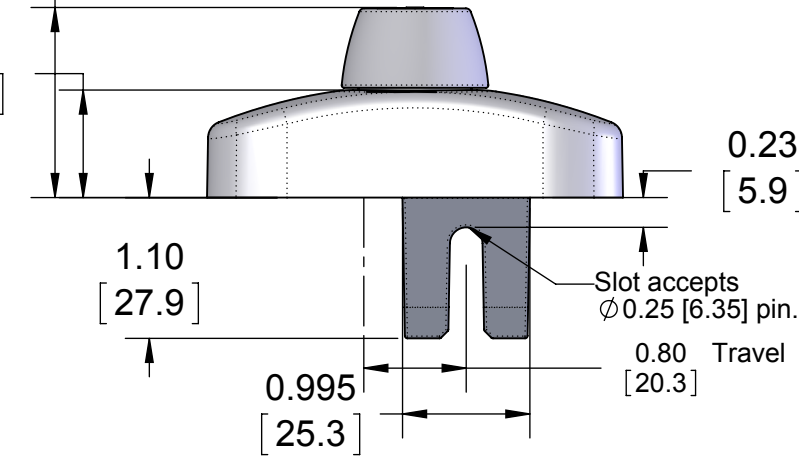

0.062
[1.6]

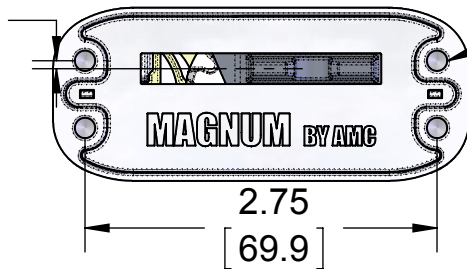

Threaded for #10-32
machine screws.

FINISH OPTIONS	
PART #	FINISH
1250-BLK	Black Powder Coat
1250-WT	White Powder Coat
1250-SC	Satin Chrome Plating
1250-SN	Satin Nickel Plating
ACCESSORIES	
1451	Wrench

1250 & 1251 Sales, Custodial "Euro" Handle Fork Drive