

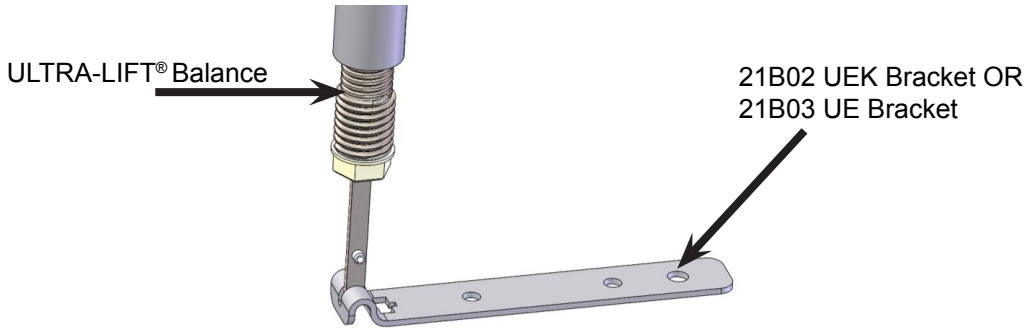

ULTRA-LIFT® Bracket Replacement

21B02/21B03 UEK/UE Bracket Replacement (Non-Tilt)



1. Remove top stops from the upper corners of the window frame.



2. Open the lower sash fully.

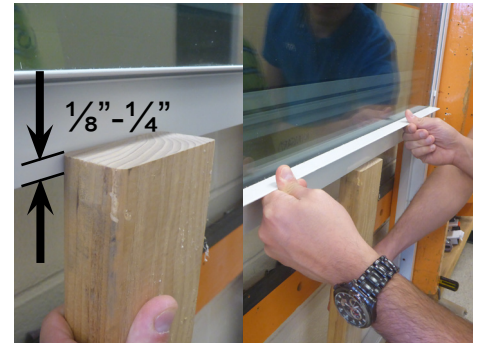

3. Use a strong prop to hold the sash in the raised position. Ensure that this prop is $\frac{1}{8}$ "- $\frac{1}{4}$ " **taller** than the opening to allow it to fully seat the balance and remove any load from the mounting brackets.

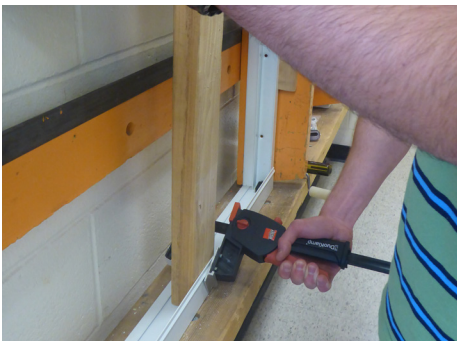

4. Be sure that the prop is securely in place to avoid the sash dropping while working on the underside. Clamp recommended.

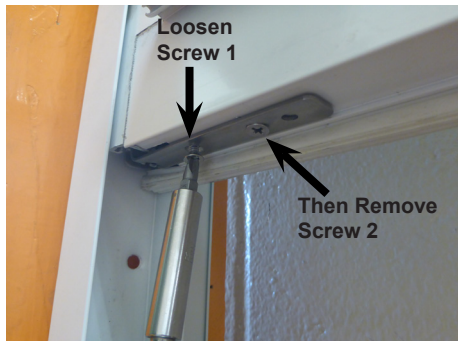

5. Begin to unscrew brackets from underside of sash. First loosen the screw closest to the corner of the sash; **do not fully remove screw 1**. Then, remove screw 2 fully.
Note: Bracket may become loose as balance tries to pull it around the corner of the sash.



6. Using a hook, grab the bracket from the empty screw hole.

SL14-105_r0 02/04/2016



ULTRA-LIFT® Bracket Replacement

21B02/21B03 UEK/UE Bracket Replacement (Non-Tilt)



7. While holding the bracket with the hook tool, fully remove the first screw. If a long enough prop is used, there should be very little tension left of the balance.

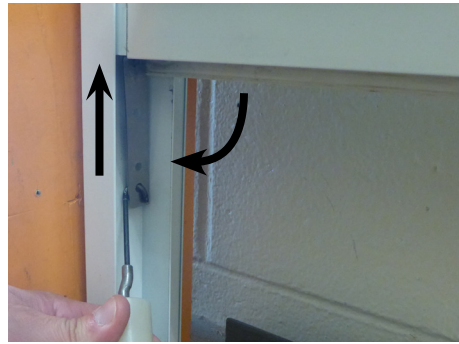

8. Using the hook tool, swing the bracket down to the jamb and push upwards to ensure the balance is fully retracted.
Repeat steps 5-8 for the balance on the other side of the sash.



9. **A second person is recommended for assistance on a heavy sash.** Carefully remove the prop and lower the sash.



10. Remove the screw from the top of the balance.



11. Lift the balance and UEK bracket out of the jamb pocket.



12. Drop the new balance with UEK bracket attached into the jamb pocket. Note: screw location and top of bracket, as noted by the arrows. Keep the balance straight and minimize flexing or bending. (Remove sash guides as necessary.)



13. Line up new balance with existing screw hole and screw new balance in place. Take care to engage the existing threads in the jamb with the new screw. **A screwdriver is recommended to avoid stripping the hole.**



14. Lift sash and securely reinstall the prop.

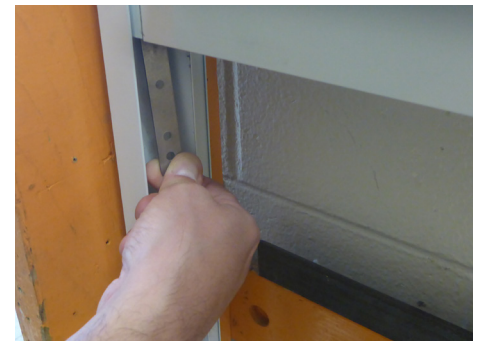

15. Confirm the bracket is in the proper orientation seen in step 12: note the top of bracket is going to swing to the bottom of the sash.

SL14-105_r0 02/04/2016



ULTRA-LIFT® Bracket Replacement

21B02/21B03 UEK/UE Bracket Replacement (Non-Tilt)

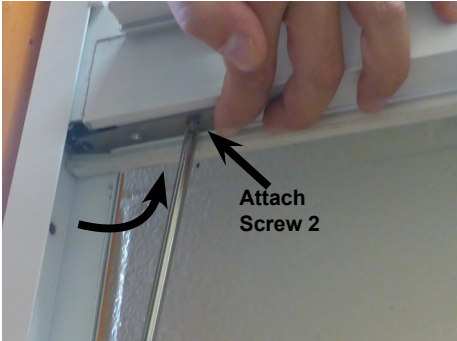

16. Swing bracket into position and attach screw 2. Use hook tool if necessary to assist.



17. Insert screw 1 into the bracket.

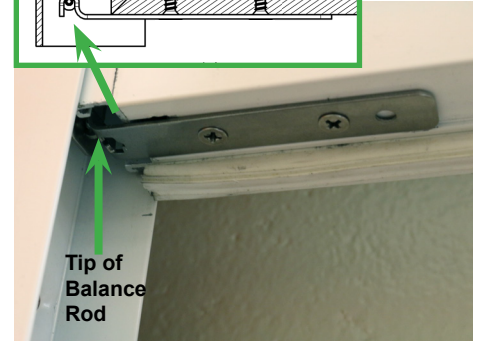
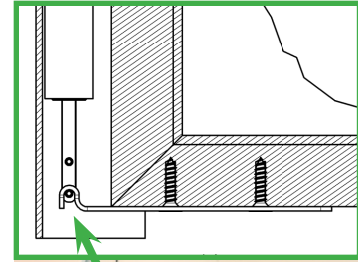

18. Check to ensure the bracket is still hooked onto the balance rod. The bracket should be on the lower pin.



19. Carefully remove the prop and slowly lower sash.
Note: Some downward force may need to be applied to disengage balances for the first cycle.



20. Replace top stops. Raise and lower sash to ensure proper operation.

02/04/2016

SL14-105_r0