

8200E Linear Extended Handle Assembly (Fork Drive)

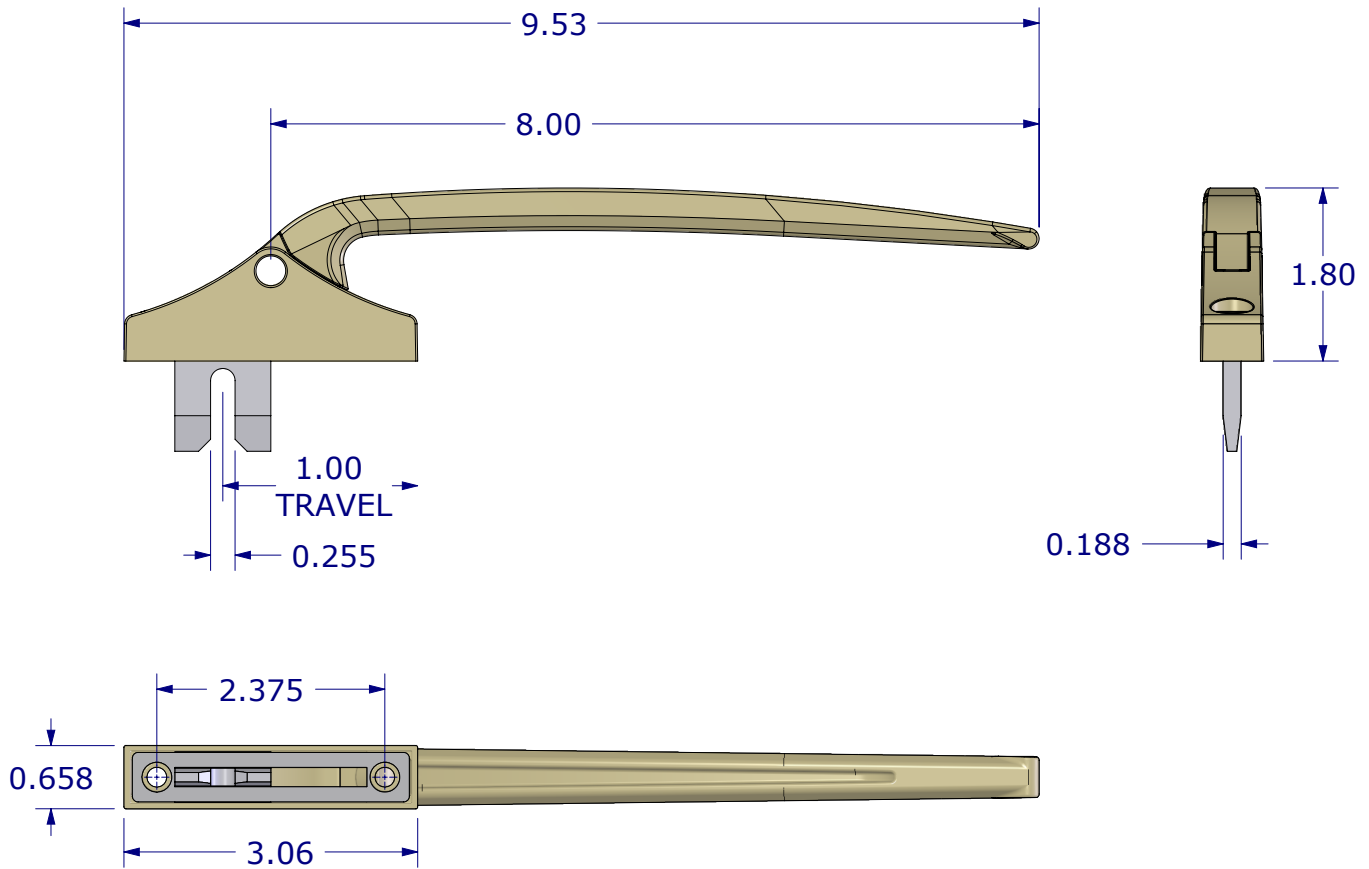

(When mounting thru material .125" or thicker, use (2) #10 x 3/4" SS Flat or Oval head screws of your choice)

#8221 BACKER PLATE

(Use when mounting thru material less than .125" thick.
(2) #10-32 x 3/4" SS Flat or Oval head screws required)

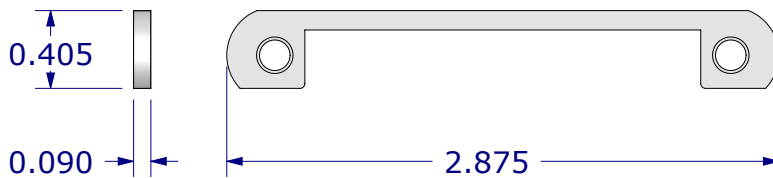

#8205 Gasket

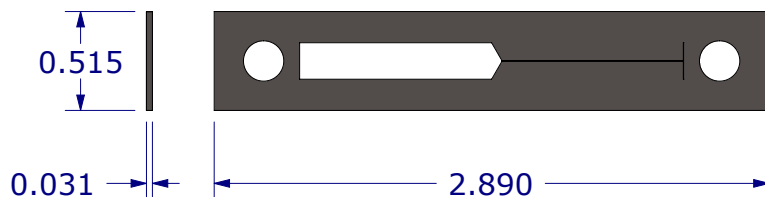

Part #	Finish
8200E-Blk	Black Powder Coat
8200E-WT	White Powder Coat
Special Order Finishes *	
Part #	Finish
8200E-CN	Soft Nickel
8200E-BNZ	Bronze
8200E-SLV	Silver

*Non-Standard Finishes
- Minimum May Apply.

8200E_r3 Sales